









FLI 60/1/FL 	FLI 60/2/FL 	FLI 70/2/FL 	FLI 90/2/FL 	FLI 100/2/FL 	FLI 120/2/FL 	FLI 120/3/FL 	FLI 130/3/FL 
--	--	--	--	---	---	---	---



Pos.	Bezeichnung <i>Pos. Désignation</i> <i>Pos. Designation</i>																	Technische Infos <i>Information technique</i> Technical information	Art.Nr. <i>Art.no.</i> Art.No.	CHF exkl. MWST.			
		CH/DE/GB	FLI 60/1/FL	FLI 60/2/FL	FLI 70/2/FL	FLI 90/2/FL	FLI 100/2/FL	FLI 120/2/FL	FLI 120/3/FL	FLI 130/3/FL	FLI 50/1/LED/L+R	FLI 60/1/LED/L+R	FLI 60/2/LED/L+R	FLI 70/2/LED/L+R	FLI 80/2/LED	FLI 90/2/LED	FLI 100/2/LED	FLI 120/2/LED	FLI 130/3/LED	FLI 150/3/LED			
1	Leuchtendeckel <i>Couvercle luminaire</i> Cover of luminaire		●	●	●	●	●	●	●	●	●	●	●	●	●	●	●	●	●	●	links / <i>gauche</i> / left rechts / <i>droite</i> / right	670.175.00.54 670.176.00.54	27.- 27.-
2	LED-Modul kpl. oben 4000K <i>LED-module compl. en haut 4000K</i> LED-module compl. top 4000K										●	●	●	●	●	●	●	●	●	●	12 W / 45,0 cm 14 W / 55,0 cm 17 W / 65,0 cm 20 W / 75,0 cm 22 W / 85,0 cm 25 W / 95,0 cm 30 W / 115,0 cm 33 W / 125,0 cm 38 W / 145,0 cm	310.561 310.562 310.563 310.564 310.565 310.566 310.567 310.568 310.569	231.- 270.- 275.- 280.- 328.- 331.- 352.- 392.- 407.-
3	LED-Modul kpl. unten 4000K <i>LED-module compl. en bas 4000K</i> LED-module compl. below 4000K										●	●	●	●	●	●	●	●	●	●	12 W / 45,0 cm 14 W / 55,0 cm 17 W / 65,0 cm 20 W / 75,0 cm 22 W / 85,0 cm 25 W / 95,0 cm 30 W / 115,0 cm 33 W / 125,0 cm 38 W / 145,0 cm	310.561 310.562 310.563 310.564 310.565 310.566 310.567 310.568 310.569	231.- 270.- 275.- 280.- 328.- 331.- 352.- 392.- 407.-
4	LED-Konverter oben <i>LED-convertisseur en haut</i> LED-converter top										●	●	●	●	●	●	●	●	●	●	20 W / 24 V 60 W / 24 V	325.303 325.305	50.- 73.-
5	LED-Konverter unten <i>LED-convertisseur en bas</i> LED-converter below										●	●	●	●	●	●	●	●	●	●	20 W / 24 V 60 W / 24 V	325.303 325.305	50.- 73.-
6	Fluoreszenzlampe oben FL <i>Tube fluorescent en haut FL</i> Fluorescent tube top FL		●	●	●	●	●	●	●	●											T5 24W/840 T5 39W/840 T5 54W/840	701.070 701.071 701.072	22.- 22.- 22.-
	Fluoreszenzlampe unten FL <i>Tube fluorescent en bas FL</i> Fluorescent tube below FL		●	●	●	●	●	●	●	●											T5 14W/840 T5 21W/840 T5 28W/840	701.065 701.063 701.066	22.- 22.- 22.-
7	Lampenfassung oben FL (Paar) <i>Douille de lampe en haut FL (paire)</i> Lampholder top FL (pair)		●	●	●	●	●	●	●	●											G5	325.204	5.-
	Lampenfassung unten FL (Paar) <i>Douille de lampe en bas FL (paire)</i> Lampholder below FL (pair)		●	●	●	●	●	●	●	●											G5	325.209	10.-
8	Vorschaltgerät oben FL <i>Ballast en haut FL</i> Ballast top FL		●	●	●	●	●	●	●	●											1 x 18-40 W (EVG) 1 x 54-58 W (EVG)	700.133 700.134	49.- 49.-
	Vorschaltgerät unten FL <i>Ballast en bas FL</i> Ballast below FL		●	●	●	●	●	●	●	●											1 x 14-35 W (EVG)	700.065	39.-
9	Lichtblende oben <i>Ecran d'éclairage en haut</i> Light diffuser top		●	●	●	●	●	●	●	●	●	●	●	●	●	●	●	●	●	●	4,9x5,8x47,8 cm 4,9x5,8x57,8 cm 4,9x5,8x67,8 cm 4,9x5,8x77,8 cm 4,9x5,8x87,8 cm 4,9x5,8x97,8 cm 4,9x5,8x 117,8 cm 4,9x5,8x 127,8 cm 4,9x5,8x 147,8 cm	681.335 681.815 681.816 681.336 681.817 681.818 681.819 681.820 681.337	31.- 33.- 36.- 39.- 41.- 43.- 48.- 51.- 56.-

Pos.	Bezeichnung <i>Pos. Désignation</i> <i>Pos. Designation</i>																Technische Infos <i>Information technique</i> Technical information	Art.Nr. <i>Art.no.</i> Art.No.	CHF exkl. MWST.					
		CH/DE/GB	FLI 60/1/FL	FLI 60/2/FL	FLI 70/2/FL	FLI 90/2/FL	FLI 100/2/FL	FLI 120/2/FL	FLI 120/3/FL	FLI 130/3/FL	FLI 50/1/LED/L+R	FLI 60/1/LED/L+R	FLI 60/2/LED/L+R	FLI 70/2/LED/L+R	FLI 80/2/LED	FLI 90/2/LED	FLI 100/2/LED	FLI 120/2/LED	FLI 130/3/LED	FLI 150/3/LED				
10	Lichtblende unten <i>Ecran d'éclairage en bas</i> Light diffuser below		●	●	●	●	●	●	●	●	●	●	●	●	●	●	●	●	●	●	●	4,3x10,5x57,0 cm 4,3x10,5x67,0 cm 4,3x10,5x87,0 cm 4,3x10,5x97,0 cm 4,3x10,5x117,0 cm 4,3x10,5x127,0 cm 0,5x4,9x47,0 cm 0,5x4,9x57,0 cm 0,5x4,9x67,0 cm 0,5x4,9x77,0 cm 0,5x4,9x87,0 cm 0,5x4,9x97,0 cm 0,5x4,9x117,0 cm 0,5x4,9x127,0 cm 0,5x4,9x147,0 cm	681.821 681.567 681.822 681.568 681.569 681.570 681.880 681.881 681.882 681.883 681.884 681.885 681.886 681.887 681.888	42.- 47.- 53.- 59.- 69.- 73.- 24.- 28.- 31.- 34.- 37.- 40.- 49.- 52.- 55.-
11	Doppelsteckdose <i>Prise de courant double</i> Double socket	CH	●	●	●	●	●	●	●	●	●	●	●	●	●	●	●	●	●	●	weiss <i>blanc</i> white	702.063	22.-	
12	Steckdose unten <i>Prise de courant vieux en bas</i> Socket below	CH			●	●	●	●	●												weiss <i>blanc</i> white	325.216	23.-	
13	Steckdose <i>Prise de courant</i> Socket	DE								●	●	●	●	●	●	●	●	●	●	●	weiss <i>blanc</i> white	702.012	17.-	
	Steckdose <i>Prise de courant</i> Socket	DE	●	●	●	●	●	●	●												weiss <i>blanc</i> white	702.001	16.-	
14	Steckdose <i>Prise de courant</i> Socket	GB	●	●	●	●	●	●	●	●	●	●	●	●	●	●	●	●	●	●	weiss <i>blanc</i> white	702.062	32.-	
15	Steckdosengehäuse <i>Boîtier de prise</i> Socket housing										●	●	●	●	●	●	●	●	●	●	weiss <i>blanc</i> white	670.186.00.02	17.-	
16	Steckdosengehäuse unten <i>Boîtier de prise en bas</i> Socket housing below				●	●	●	●	●												weiss <i>blanc</i> white	670.161.00.02	17.-	
17	Klappdeckel <i>Couvercle</i> Hinged cover	GB/DE	●	●	●	●	●	●	●	●	●	●	●	●	●	●	●	●	●	●	weiss <i>blanc</i> white	702.014	17.-	
18	Abdeckrahmen 1-fach <i>Cadre de recouvrement simple</i> Single cover frame		●	●	●	●	●	●	●	●	●	●	●	●	●	●	●	●	●	●	weiss <i>blanc</i> white	6,0x6,0 cm 702.044	4.-	
19	Doppelwippschalter-Einsatz <i>Insert interrupteur à bascule double</i> Double rocker switch insert										●	●	●	●	●	●	●	●	●	●		702.024	18.-	
20	Doppel-Flächenwippe <i>Bascule planiforme à double</i> Double rocker switch										●	●	●	●	●	●	●	●	●	●	weiss <i>blanc</i> white	702.025	10.-	
21	Schaltensor oben <i>Interrupteur du capteur en haut</i> Sensor switch top		●	●	●	●	●	●	●													702.457	63.-	
22	Schaltensor unten <i>Interrupteur du capteur en bas</i> Sensor switch below		●	●	●	●	●	●	●												L = 850 L = 1500	702.456 702.459	63.- 63.-	
23	Leistungsteil Sensor <i>Partie puissance du capteur</i> Power element sensor		●	●	●	●	●	●	●													705.038	131.-	
24	Blindplatte <i>Couvercle</i> Cover	GB																		●	manhattan <i>manhattan</i> 3,8x5,0cm manhattan	670.191.00.04	7.-	
25	Blindplatte <i>Couvercle</i> Cover	CH/GB	●	●	●	●	●	●	●												weiss <i>blanc</i> white	670.162.00.02	8.-	

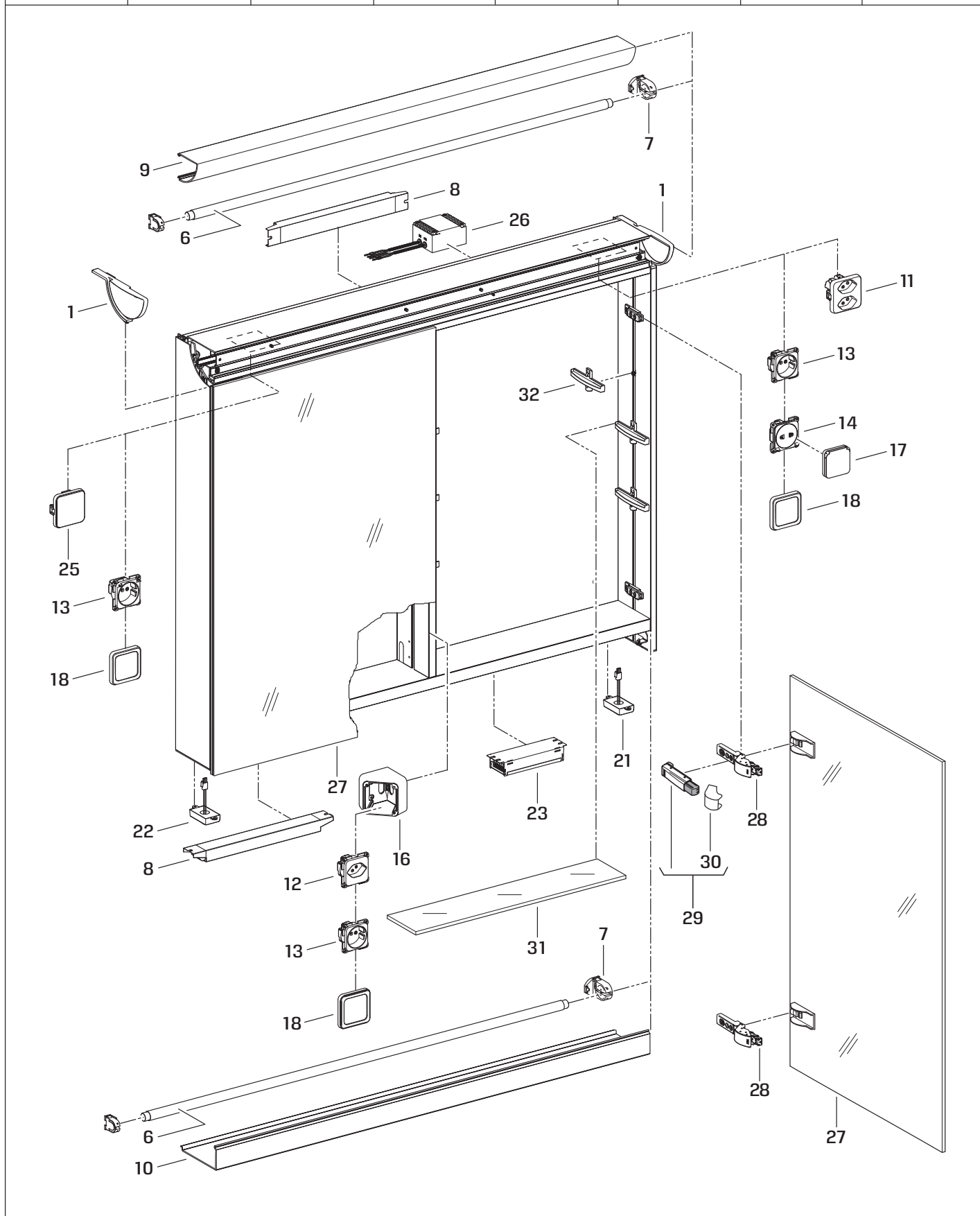
Pos.	Bezeichnung <i>Désignation</i> Designation																	Technische Infos <i>Information technique</i> Technical information	Art.Nr. <i>Art.no.</i> Art.No.	CHF exkl. MWST.					
		CH/DE/GB	FLI 60/1/FL	FLI 60/2/FL	FLI 70/2/FL	FLI 90/2/FL	FLI 100/2/FL	FLI 120/2/FL	FLI 120/3/FL	FLI 130/3/FL	FLI 50/1/LED/L+R	FLI 60/1/LED/L+R	FLI 60/2/LED/L+R	FLI 70/2/LED/L+R	FLI 80/2/LED	FLI 90/2/LED	FLI 100/2/LED	FLI 120/2/LED	FLI 130/3/LED	FLI 150/3/LED					
26	Transformator <i>Transformateur</i> Transformer	GB	●	●	●	●	●	●	●	●	●	●	●	●	●	●	●	●	●	●	●	240V/6,8x5,7x3,5 cm	705.034	103.-	
27	Spiegeltüre L/R ohne Scharnier <i>Porte à miroir G/D sans charnière</i> Mirror door L/R without hinge		●	●			●	●			●	●	●					●	●			49,5x70,0 cm 59,5x70,0 cm 29,6x70,0 cm 34,5x70,0 cm 39,5x70,0 cm 44,5x70,0 cm	688.205 688.206 688.200 688.201 688.203 688.204	120.- 137.- 98.- 109.- 104.- 115.-	
	02.2019 ⇨				●																				
	Spiegeltüre M ohne Scharnier <i>Porte à miroir C sans charnière</i> Mirror door C without hinge							●		●									●	●			59,5x70,0 cm 29,6x70,0 cm	688.209 688.207	142.- 94.-
	02.2019 ⇨																								
(27)	Spiegeltüre L/R ohne Scharnier <i>Porte à miroir G/D sans charnière</i> Mirror door L/R without hinge		●	●	●		●	●			●	●	●					●	●			49,5x70,0 cm 59,5x70,0 cm 29,6x70,0 cm 34,5x70,0 cm 39,5x70,0 cm 44,5x70,0 cm	305.422.00.xx 305.423.00.xx 305.420.00.xx 305.454.00.xx 305.421.00.xx 305.427.00.xx	136.- 152.- 110.- 117.- 119.- 124.-	
	⇨01.2019																								
	Spiegeltüre M ohne Scharnier <i>Porte à miroir C sans charnière</i> Mirror door C without hinge							●		●									●	●			59,5x70,0 cm 29,6x70,0 cm	305.426.00.xx 305.424.00.xx	152.- 110.-
	⇨01.2019																								
28	Scharnier <i>Charnière</i> Hinge		●	●	●	●	●	●	●	●	●	●	●	●	●	●	●	●	●	●	●		mit Feder <i>avec ressort</i> with spring	710.040	27.-
29	Türdämpfer <i>Amortisseur de porte</i> Soft door closure		●	●	●	●	●	●	●	●	●	●	●	●	●	●	●	●	●	●	●		vernickelt <i>nickel plaqué</i> nickel plated	710.047	13.-
30	Ersatzkappe für Türdämpfer <i>Couvercle de res. pour amortisseur de porte</i> Spare cap for soft door closure		●	●	●	●	●	●	●	●	●	●	●	●	●	●	●	●	●	●	●			710.051	6.-
31	Glasablageset (2 Ablagen) <i>Set de tablette en verre (2 pièces)</i> Glass shelf set (2 pieces)		●	●	●						●	●	●									46,4x8,4x0,6 cm 56,4x8,4x0,6 cm 66,4x8,4x0,6 cm 37,1x8,4x0,6 cm 42,1x8,4x0,6 cm 47,1x8,4x0,6 cm 57,1x8,4x0,6 cm 27,8x8,4x0,6 cm 27,1x8,4x0,6 cm 57,8x8,4x0,6 cm	686.235 686.236 686.096 686.234 686.237 686.239 686.238 686.240 686.671 686.678	19.- 22.- 27.- 18.- 18.- 20.- 23.- 15.- 15.- 23.-	
32	Ablageträger (Paar) <i>Support de tablette (paire)</i> Shelf holder (pair)		●	●	●	●	●	●	●	●	●	●	●	●	●	●	●	●	●	●	●		transparent <i>transparent</i> transparent	325.196	14.-